



AQUON One

3 cabins layout*

TECHNICAL SPECIFICATION

* AQUON One is available also as 2- and 4 cabins layout.
Differences to these are marked in italics in this specification

Swiss Sustainable Yachts AG
Brandschenkestrasse 24
8001 Zurich, Switzerland

Christine Funck
christine.funck@aquon.ch
+41 79 8090 808

Table of contents

Specification	3
Getting on board	4
Cruising to destination	4
First night on board, interior areas	4
At destination	6
Utilities	6
Household and Tableware	7
Safety	7
General instructions	7
Support / Helpline	7
Eco- / sustainability highlights	7
Floorplans	8
Exterior	9
Interior	10



Specifications

Type of vessel

Luxurious and sustainable ocean-going motor catamaran with PV (Photovoltaic) / Hydrogen propulsion

Living space

107 sqm / 1152 sq ft interior area, 144 sqm / 1550 sq ft exterior area, plus technical spaces, storage and service spaces.

Maximum overnight capacity

6 + 3 (3-cabin layout)

4 + 4 (2-cabin layout)

8 + 2 (4-cabin layout)

Hull construction

Composite, E glass/Carbon infused Vinilester resin

Paint

Awlgrip system, choice of 4 AQUON standard pearlescent colours or individual colour in consultation with AQUON designer

Length over all (LOA)

19.48 m / 64 ft

Beam

9.49 m / 31.1 ft

Draft (loaded condition)

0.75 m / 2.5 ft

Height above waterline (Air draft)

7.54 m / 24.8 ft

Displacement

30 metric tons

Electric motors

2 x 100 kW

Cruising speed / top speed / Eco-mode

8 knots / 16 knots / 6 knots

Cruising range

Depending on type of journey, please consult dedicated "AQUON One Use Cases brochure"

Area of photovoltaic cells

70 m²

Freshwater capacity

2 x 400 liters in stainless steel tanks combined with 160 liters hourly generating capacity

Grey-/Blackwater capacity

700 + 700 liters in holding tanks combined with 2000 liters daily sewage treatment capacity

Classification

EC-certification according Directive 2013/53/EU (Module B, Design Category A), full Ocean-going capacity, survey and certification by DNV-GL

Getting on board

Passerelles

- Aft teak and stainless steel passerelle plus fwd carbon passerelle
- Two passerelles provided so that AQUON One can also be docked either "stern to pier" or "bow to pier" for more privacy in aft cockpit area
- Both passerelles designed for safe and comfortable use

Tendergarage

- Hidden garage with appropriate deployment / retrieval system for RIB-type battery operated tender max. 2.95 m / 9.7 ft long (tender not included)

Mooring

- 6 fairleads, 6 retractable cleats, 4 capstans, 10 fenders 80 x 20 cm
- Loose line ends are stored invisibly behind dedicated hatches

Anchor

- Integrated self-stowing anchor with appropriate chain, rope and electric windlass
- Controlled from Main Deck wheelhouse and Fly Deck helm station

Cruising to destination

Wheelhouse

- Helm seat, console, storage cabinet
- Sliding privacy doors to dining area
- Direct access* to Captain's cabin (*only in 2- and 3 cabin version)
- Direct access to foredeck via pantograph door
- Red night lighting
- Steering wheel, joystick, full set of instrumentation and control elements
- Navigation system including Raymarine multifunction displays, radar, AIS, Autopilot, VHF radio
- Raymarine Docksense docking system
- Steiner Commander Global 7x50 marine binoculars

Fly Deck Helm Station

- Large Helm bench, 2-part angled full custom console, red night lighting
- Steering wheel, instrumentation and control elements

Propulsion system

- 2 x 75 cm dia propellers with shafts, struts, stern tubes, shaft seals, thrust bearings and CV joints
- 2 x liquid cooled electric motors rated 100 kW @ 2400 rpm, controlled from Wheelhouse and Fly Deck Helm station

Bowthruster

- Twin bowthruster system, controlled from Wheelhouse and Flydeck Helm Station

Steering system

- Electro-hydraulic twin disc system, controlled from Wheelhouse and Flydeck Helm Station
- Redundant with manual Emergency System

Navigation lighting etc

- Side lights port and starboard, stern light and mast head light
- Anchor ball 12 x deck lights
- 1 x portable searchlight
- Stern docking lights, ship's horn
- Set of signalisation flags

First night on board, interior areas

LOWER DECK IN PORT SIDE (LEFT SIDE) HULL

Aft Guest Cabin

- Double bed with bedside tables. 2 wardrobes. Desk with soft closing vanity/mirror and stool
- Built-in safe
- En suite bath with shower

Central Corridor with Bath

- Cabinets and wardrobes, built-in glass-door wine cooler, bath with shower

Fwd Guest Cabin

- Double bed with bedside tables
- Wardrobe and cabinet
- Desk with soft closing vanity/mirror and stool
- Built-in safe

Bow Crew Cabin

- Single bed, wardrobe, integral washstand and toilet

(In 2-cabin layout, the Port side hull will be the mirrored layout of the below described Starboard side hull)

LOWER DECK IN STARBOARD SIDE (RIGHT SIDE) HULL

Master Cabin

- Double bed with bedside tables
- Occasional sofa
- Large walk-in wardrobe with sliding doors
- Large cabinet
- Large desk with soft closing vanity/mirror and stool
- Built in file-size safe
- Private stair to Main Deck

Ensuite Master Bath

- Large shower, double washstand, separate toilet and bidet

Fwd Crew Cabin

- Single bed (optional second bunk bed), wardrobe and cabinet, en suite washstand and toilet
- Direct stair to wheelhouse

(In 4-cabin layout, the Starboard side hull will be the mirrored layout of the above described Port Side hull)

LOWER DECK INTERIOR - GENERAL ITEMS

- Soft-mounted interior to insure maximum acoustical comfort- and privacy levels
- Custom-fitted Roviva Swiss premium mattresses, 3Dmesh ventilation underlay
- Wardrobes with hanging space, drawers and shelves, inner lighting, ventilation slots
- Wardrobe upon request possible in untreated cedar wood
- Integrated holder for glass of water at bedsides
- USB charging sockets, reading lights, courtesy night lights, hairdryer
- State-of-the-art large TV screens
- Sinks, taps, shower separations etc. as shown in renderings
- Showers include rainfall plus handheld
- Bath mirrors include illuminated magnifying mirror and shelves behind
- Toilets are full size

MAIN DECK INTERIOR

Living Area

- Large 3- and 2 seater sofas, low table, 2 poufs, 2 armchairs, coffee table
- 2 sideboards at windows plus large central sideboard containing bottle storage
- Built in "home-office cabinet" (lockable) under starboard Fly Deck stair
- Aft sliding doors, stainless steel framed
- Wood/glass division to stairs

Dining Area

- Dining table and chairs for eight
- Large 2-seater low sofa, large sideboard
- Skylight over table
- Sliding doors to kitchen / wheelhouse
- Large TV screen on forward separation wall

LOWER -/MAIN DECK INTERIOR GENERAL DETAILS

General

- Motorized curtains
- Lower Deck Cabins feature additional integrated opening portholes

- Illumination by company "Apure" that achieves the most aesthetic appearance for each individual space. Glare-free almost invisible ceiling downlights create the perfect mood, which (either automatically or manually) adapts to time of day, ambient light, specific situation,...
- Decorative sofa-/lounge cushions as shown in renderings
- All stairs designed for safe and comfortable use and including linear LED orientation lighting
- Usable space is made accessible for storage

Furniture details

- All furniture/cladding etc. panels in plywood composite or comparable, with appropriate edging/reinforcements for low weight construction
- All doors, drawers equipped against unintentional opening
- All hinges and hardware anti-rattle
- Dampened/self-closing operation wherever possible
- Flush compression locks on revision panels
- Custom made upholstery with premium foam with varying densities according use

Materials

- Floors in recycled leather (possibly vegan alternative, under investigation) or cork (baths) and with high quality carpets in living area
- Walls in bamboo, cork, recycled leather, various lacquers, smoked glass
- Furniture in lacquer, cork, metal, wooden veneer
- Upholstery and curtains in fabric
- Various special surfaces
- Ceilings lacquered
- All materials as shown in Designer's renderings
- All materials chosen for best sustainability
- All materials according to actual samples signed free for production by the Owner
- Fabrics (upholstery, cushions, curtains) as per selection shown in renderings or choice of alternative fabrics in consultation with AQUON designer

Entertainment, communication, connectivity

- Bose entertainment center and speakers, i70s Instruments with anemometer, GPS antenna, Compass, Satellite TV, State-of-the-art communication
- Internet access, WLAN, custom AQUON Sm@rt home system

Main Kitchen

- L-shaped quartz worktop, with full-height rear cabinet
- Access to dining area via sliding door, access to Foredeck via pantograph door
- Beautiful view while cooking
- Full set of top-of-the-range appliances, all in full household-size
- Induction hob KM 7897 FL, 90 cm wide, free-zone induction with custom removable potholders
- Retracting Miele DA 6890 exhaust system
- Steamer oven Miele DGC 7860, auto-opening door, mounted at waist height

- Coffeemaker Miele CVA 7440
- Side-by-side fridge/freezer with icemaker Miele FNS 28463/KS 28463 full height /width
- Dishwasher Miele G 7965 SCVi XXL with auto-opening door
- Large and deep Franke stainless steel sink and tap
- Under-sink macerator Insinkerator Evolution 200
- Drinking water tap Sprudelux (adjustable cooling and carbonation)
- Sensor activated integrated dual Hailo trashbin
- Drawers and storage

(Type indications are indicative, respective follow-up models may be installed. Individual preferences will be considered)

At destination

Main Deck aft Lounge Area

- 2 soft chaises longues, 2 poufs

Main Deck aft Dining Area

- Table and chairs for 6

Main Deck forward Sitting Area

- 2 L-shaped sofas, 2 low tables

Fly Deck aft Sitting Area

- Aft seating for 12+ persons for sit-down dinner
- Table tops adaptable in size (folding tops) and adjustable in height to allow variety of uses.

Fly Deck AI Fresco Cooking Station

- Straight extra deep quartz counter
- Induction Teppanyaki surface 58 cm wide, Induplus 580, full outdoor rating
- Cook's side refrigerator "door type" with shelves, Bull 13700, full outdoor rating
- Guest side bottled drinks refrigerator "2 drawers type" Bull 1370, full outdoor rating
- Large and deep Franke stainless steel sink and tap
- Under-sink macerator Insinkerator Evolution 200
- Drinking water tap Sprudelux (adjustable cooling and carbonation)
- Sensor activated integrated dual Hailo trashbin
- Drawers and storage

(Type indications are indicative, respective follow-up models may be installed. Individual preferences can be considered)

(Fly-Deck Helm Station is described earlier in this Specification)

Fly Deck forward Relaxing Area

- 4 upholstered sun pads

Exterior general details

- Structure in painted composite
- Sustainable synthetic teak, still under investigation
- Glass/stainless steel handrails, railings, balustrades
- Stairs and steps with linear LED orientation lighting
- Fixed furniture in stainless steel, composite, sustainable synthetic teak
- All upholstery (including cushions as shown in renderings) custom made with quality foam in varying densities depending use
- All foam cores encapsulated watertight
- All fabrics high quality suitable for marine outdoor use
- Fabrics (upholstery, cushions, curtains) as per selection shown in renderings or choice of alternative fabrics in consultation with AQUON designer
- Illumination by company "Apure" that achieves the most aesthetic appearance for each individual space. Glare-free almost invisible ceiling downlights create the perfect mood, which (either automatically or manually) adapts to time of day, ambient light, specific situation,...
- Usable space is made accessible for storage

Leisure details

- 1 x dismountable exterior shower, bathing ladder, steward-call system integrated in AQUON sm@rt home system

Utilities

Energy system

- 70 m² photovoltaic cells adapted to curved structure
- Short term storage in Li Ion batteries (see below in electrical system)
- Long term storage via electrolyser with compressor generating hydrogen
- Hydrogen upon demand is converted back into electricity by Fuel cell
- Generated thermal heat is used for on-board hot water supply

Electrical system

- HV batteries
- 24 V batteries
- 12 V batteries
- Shore power chargers, system management unit, MPP tracker
- DC/DC converter 2,8 kW, DC/AC inverter 15 kW, solar charger 10 kW
- 230 V 50 Hz power in accomodation area, earth leakage safety trips
- All required power and signal cabling and cable trays, junction boxes,...

Hydraulic system

- Hydraulic unit, 3 hydraulic pistons (2 x Lazarette hull, 1 x tender garage), all required accessories and piping

A/C system

- Webasto chiller 77.000 BTU/h for cooling and reverse-cycle heating, with 11 dedicated scaled Webasto air handlers with individual local touchscreen control units.
- Air handlers positioned to insure easy access / servicing

- Fresh air supply and exhaust included
- Customised expansion boxes and custom made ventilation slots integrated discretely and carefully in the interior outfitting. Positioning and dimensions optimised to insure high level of comfort
- "Off-time"-function in combination with integrated sm@rthome system to maintain interior climatic conditions within set limits to insure longevity of interior outfitting

Freshwater system

- Portside and Starboard side filling plugs, 2 x 400 liter tanks (Stainless steel grade 316)
- Reverse-osmosis type watermaker with 160 liters hourly capacity
- Water heater 200 liters capacity, warm water circulation
- Full set of filters (calcite, carbon) plus UV-sterilization unit for reliable drinking water quality
- All required piping, valves, ventilated loops, through-hull fittings, pumps, strainer, water pressure unit, surge damper, etc.

Grey-/Black water system

- 2 x 350 liters grey water tanks with carbon no-smell filters, local shower sumps with extraction pumps, transfer pump
- 2 x 350 liters black water tanks with carbon no-smell filters, toilet macerator pumps, macerator transfer pump
- Biological sewage treatment plant 2000 liters/day capacity
- All required piping, valves, ventilation plugs, trough-hull fittings, pump-out deck plugs, etc.

Bilge system

- 6 x el. Bilge pumps (3028 liters/hour), 6 x manual bilge pumps (45 liters/min), 2 x drain, 6 x bilge level alarm
- All required piping, hoses, valves, ventilated loops, bilge strainers, trough-hull fittings

Household and Tableware

- Top-of-the-range appliances, all in full household-size
- Washing machine Miele WWV 980 WPS Passion, 7 kg capacity
- Dryer Miele TWV 680 WP Passion 9 kg capacity
- Swiss premium steam ironing station Laurastar with auto-off timer
- Miele vacuum cleaner
- Brooms, brushes
- Additional washing-basin near washing machine
- Motorized trash compactor system with refrigeration
- Set of custom made lashings for loose furniture during rough passage
- Starter-set of consumables for household appliances, selected with priority placed on best ecological/sustainability values

Various

- Set of waterproof breathable textile covers for all exterior furniture that cannot be otherwise stowed
- Set of textile shading covers with Tenax fixation for front windows on Main Deck
- Flag post and flag

(A list of possible options is available from us upon request)

Safety

- The hydrogen energy system and its components are certified by DNV GL both individually and combined as a system
- AQUON One is constructed and built to fulfil EC-certification according Directive 2013/53/EU (Module B, Design Category A), full Ocean going capacity.
- Survey and certification is performed by DNV-GL **This certification includes the Lithium battery set**
- All required certificates will be handed to the Owner at delivery
- Full set of safety equipment according to full satisfaction of certification requirements is included and appropriately installed/ stored on board. (Details available upon request)
- Full custom lightning protection system installed
- No gasoline or diesel is stored on board

General instructions

- The Owner (or their Representative) will receive a detailed and personal hands-on instruction-session and manual on proper use, care and maintenance of the Yacht.
- The Owner will receive a full set of dedicated and detailed manuals, plans (as-built-documentation) and instructions, this will also include a full list of all required service / maintenance points / dealerships for appliances, equipment etc.
- The boat will be equipped with a set of quality tools and a starter set of consumables matched to enable routine standard adjustments, care and maintenance work

Support / Helpline

- The Builder will be available 24/7 to answer any specific questions and assist when the Yacht is operation

Eco-/Sustainability highlights

- Generation and storage of green hydrogen on board
- Fully energy-autonomous cruising is possible (see "AQUON One - use cases")
- Only clean water vapour as exhaust
- No combustion engine installed
- No fossil fuel stored on board
- Interior and exterior materials sustainable wherever possible
- Hull and structural composite with maximum possible proportion of sustainable materials
- No sewage pumped overboard in harbour or underway
- Installation of additional microplastic-filter under investigation
- Non-toxic underwater paint. Only minimal noise pollution in accordance with UN guidelines for lowest possible disturbance of marine underwater life

Floorplans

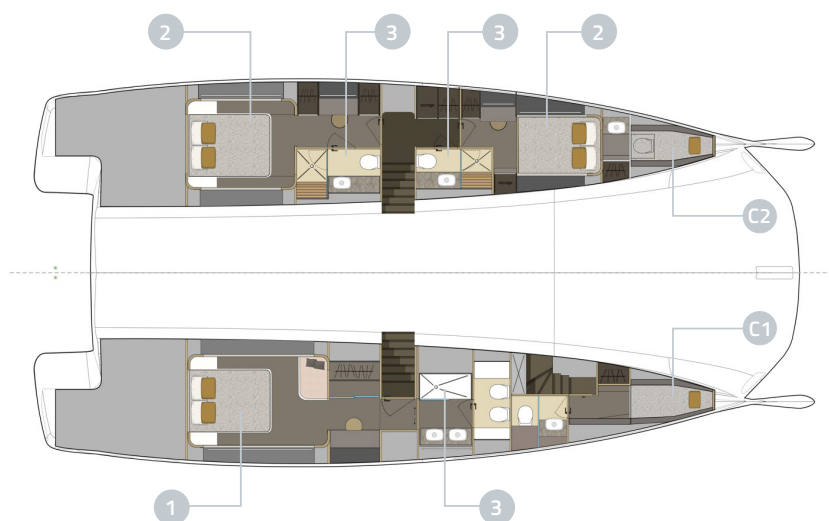

LOWER DECK - THREE CABINS

- 1 Owner Bedroom
- 2 Guest Bedrooms
- 3 Bathrooms
- C1 Captain Cabin
- C2 Crew Cabin

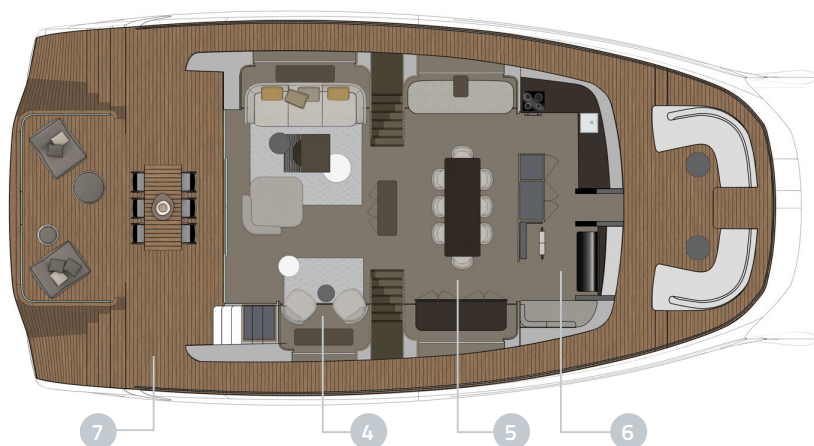

MAIN DECK - THREE CABINS

- 4 Living Area
- 5 Dining Area
- 6 Kitchen+Console
- 7 Main deck



FLYBRIDGE

- 8 Flybridge deck

Exterior



Interior



Disclaimer: Technical details of this vessel correspond to the actual status of the vessel. They are subject to change and amendment without prior notice. All information, including but not limited to technical data and illustrations are for information purposes only. They do not constitute part of a sales offer and/or sales contract. The Company disclaims all liability for any damages or consequential damages resulting from the use of or access of (or the inability to use or access) the information on this vessel from this website. | Revision 03 dated 2021-07-01

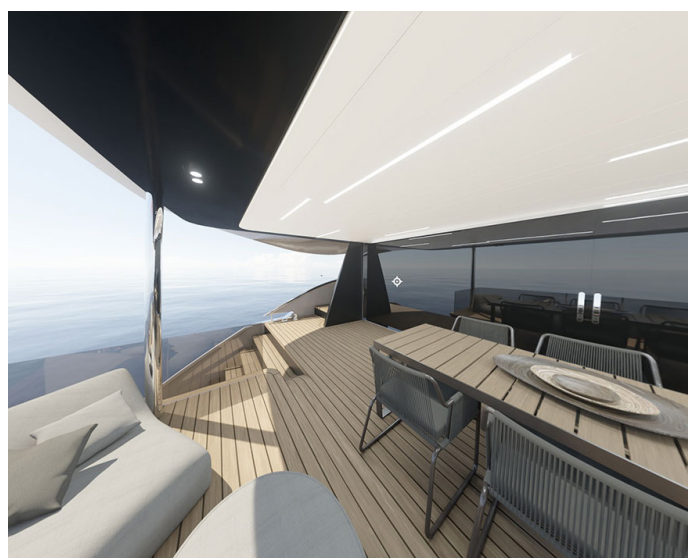



PIONEER OF
SUSTAINABLE YACHTING

Contact information

Swiss Sustainable Yachts AG

Brandschenkestrasse 24
8001 Zurich, Switzerland

Christine Funk

christine.funk@aquon.ch

+41 79 8090 808